

# Harn Ritma

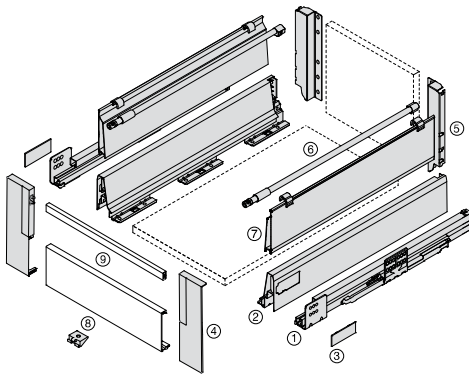

Round Railing

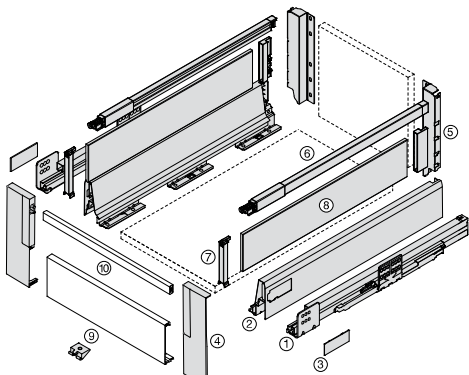

Square Railing

## Ritma Cube Inner Drawer – HS

- Soft close roller bearing concealed runners
- Full extension with synchro control
- Steel drawer side 83mm (229mm to top of railing)
- Round Side Rail and Square Side Rail options
- Load capacity of 35kg or 60kg
- Quick assembly
- Sylent integrated cushioning system
- Integrated lateral stabiliser

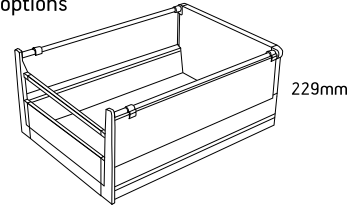

	Kit Part No.	Size	Sales Unit
<b>Round Railing Set</b>			
White 35kg	RKI8335HS.WH	350mm	Kit
	RKI8340HS.WH	400mm	Kit
	RKI8345HS.WH	450mm	Kit
	RKI8350HS.WH	500mm	Kit
	RKI8355HS.WH	550mm	Kit
White 60kg	R6RKI8345HS.WH	450mm	Kit
	R6RKI8350HS.WH	500mm	Kit
	R6RKI8355HS.WH	550mm	Kit
<b>Square Railing Set</b>			
White 35kg	RKI8335HSQ.WH	350mm	Kit
	RKI8340HSQ.WH	400mm	Kit
	RKI8345HSQ.WH	450mm	Kit
	RKI8350HSQ.WH	500mm	Kit
	RKI8355HSQ.WH	550mm	Kit
White 60kg	R6RKI8345HSQ.WH	450mm	Kit
	R6RKI8350HSQ.WH	500mm	Kit
	R6RKI8355HSQ.WH	550mm	Kit

### Cutting Dimensions

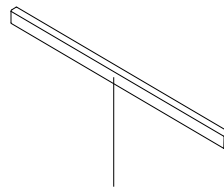

Internal Cabinet Width -122mm

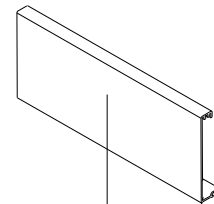

Internal Cabinet Width -132mm

\*Grey parts are included in kit

## Space Requirements & Front Installation Dimensions

### Round Rail

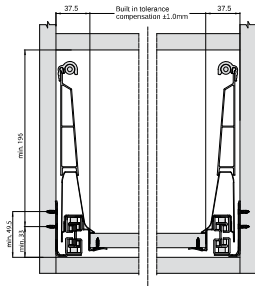

### Square Rail

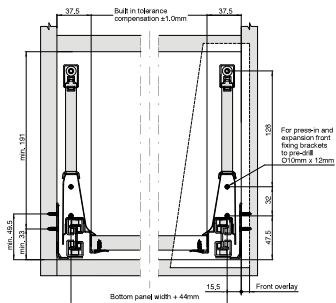

## Back Installation Dimensions

### Round Rail

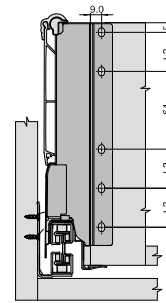

### Square Rail

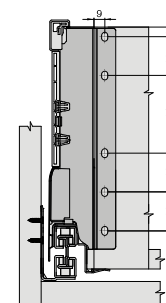

## Cabinet Profile Screw Positions

### 35kg

#### Drawer Length

Min. internal cabinet depth = drawer length + 3 mm  
Actual loss of extension = 0 mm

270, 300, 350 mm

400 mm

450 mm

500, 550 mm

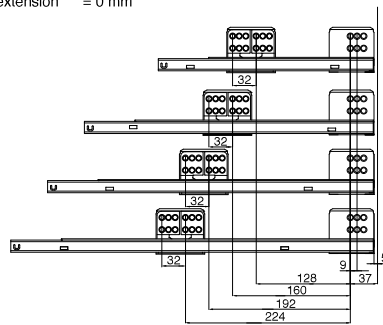

### 60kg

#### Drawer Length

Min. internal cabinet depth = drawer length + 3 mm  
Actual loss of extension = 0 mm

400 mm

450 mm

500, 550 mm

600, 650 mm

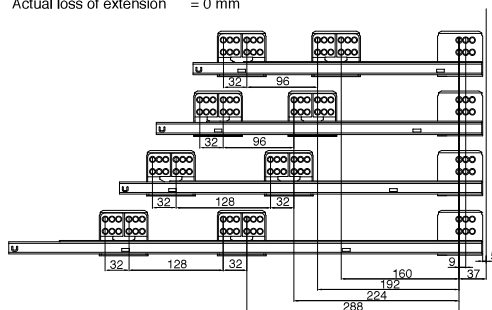

## Cutting Dimensions for 16mm Chipboard

### Back panel

Width = internal cabinet width - 87mm  
Height = 199mm

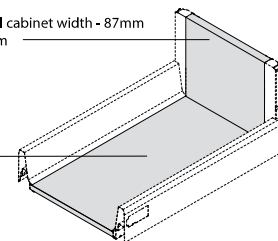

### Bottom panel

Width = Internal cabinet width - 75mm  
Length = drawer length - 24 mm

## Pre-drilling Dimensions of Bottom Panel for fixing Euro Screws

